

Thermoseal Wall Wrap XP PLUS

RESIDENTIAL WALL WRAP

Bradford Thermoseal Wall Wrap XP PLUS is a double sided reflective foil that provides boosted thermal performance and added weather protection for brick veneer walls.

Thermoseal Wall Wrap XP PLUS has a unique patterned aluminium antiglare surface that reflects up to 91% of the sun's radiant heat. The antiglare surface is laminated to a woven polymeric fabric and an inward facing aluminium foil surface with fire retardant adhesives.

SPECIFICATION TABLE

	Roll Size (m x mm)	m ² per roll	Product Code
Thermoseal Wall Wrap XP PLUS	60 x 1350	81	137041

CLASSIFICATIONS

CRITERIA	REFERENCE	RESULT
Emittance	AS/NZS 4201.5:1994/ASTM E408	Double-sided reflective Antiglare (outer face) E0.09 Silver (inner face) E0.05
Duty	Table 1 – AS/NZS 4200.1:1994	Medium duty
Vapour Barrier	ASTM E96	High
Water Barrier	AS/NZS 4201.4:1994	High
Shrinkage	AS/NZS 4201.3:1994	≤0.5%
Resistance to Dry De-Lamination	AS/NZS 4201.1:1994	Pass
Resistance to Wet De-Lamination	AS/NZS 4201.2:1994	Pass
Surface Corrosion	AS/NZS 4859.1:2002	Pass
Flammability Index	AS 1530.2	Low (≤5)

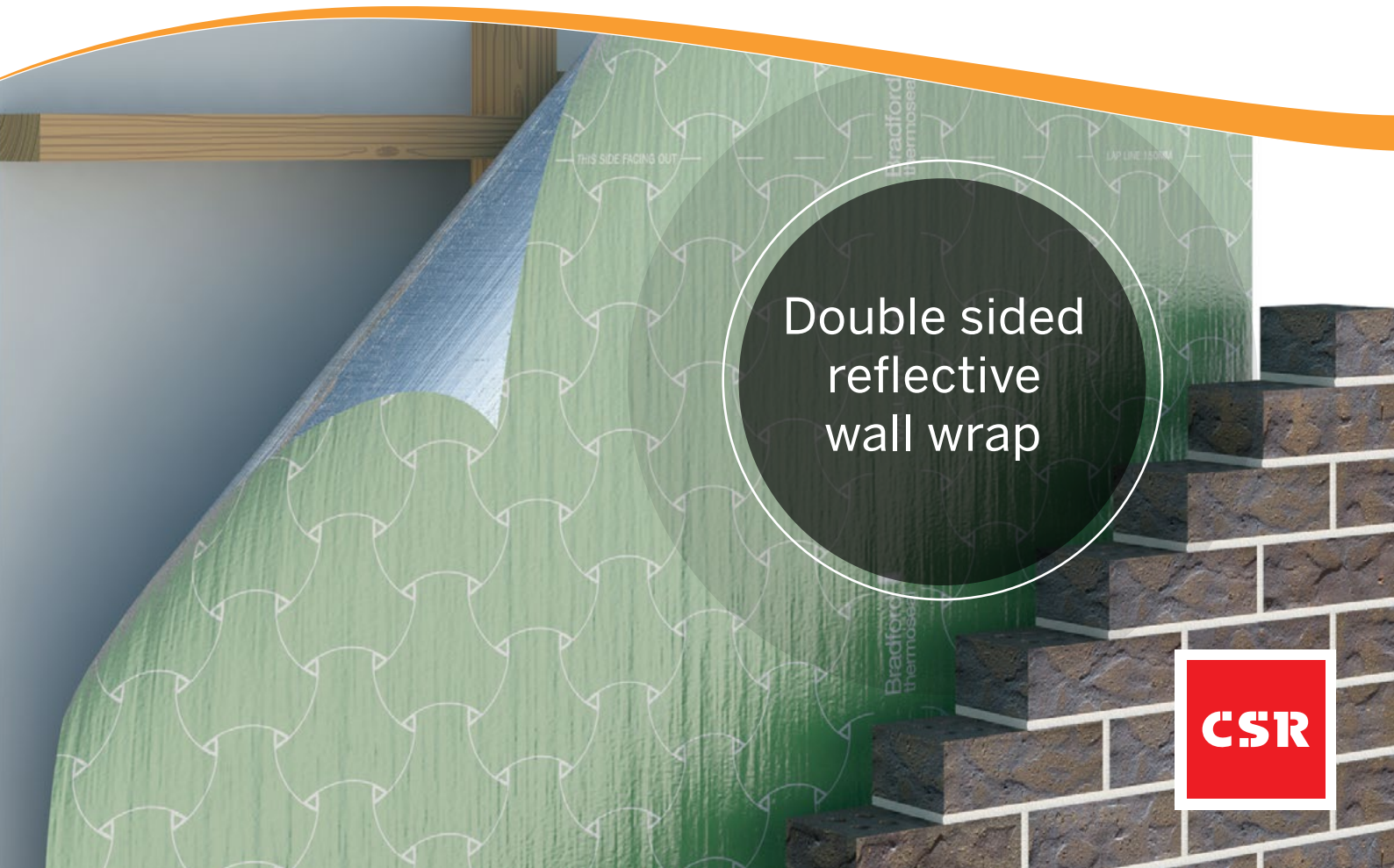

Double sided
reflective
wall wrap

Thermoseal Wall Wrap XP PLUS

TOTAL R-VALUE PERFORMANCE

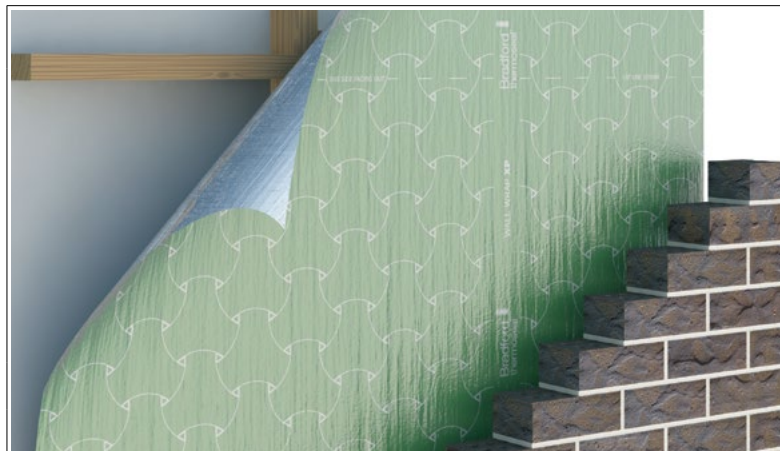

Brick Veneer Wall	
1. 110mm external brick wall	
2. 40mm reflective air gap	
3. Thermoseal Wall Wrap XP PLUS	
4. 70mm reflective air gap	
5. 10mm plasterboard	
$R_T 1.6$	$R_T 1.9$
Summer	Winter

INSTALLATION GUIDE

- Read Electrical Safety Warning (below) and install in accordance with AS/NZS4200.2.
- Install with the patterned antiglare surface facing outwards.
- Affix using either battens/top-hats or staples, Bradfix Plasti-Grip washers, fasteners at 300mm centres.
- To act as a draught and vapour control membrane, all overlaps & discontinuities should be sealed.
- Follow all relevant OHS and statutory regulations – eye protection from sun glare is recommended.

TOTAL R-VALUE ASSUMPTIONS

The contribution of this product to a Total R-Value depends on the installation and environmental conditions. The Total R-Value will be reduced in the event of the accumulation of dust on upward facing surfaces and in those cavities that are ventilated.

Thermal calculations are based on Australian parameters and in accordance with AS/NZS 4859.1:2002/Amdt.1. The contribution of this product towards the Total R-Value depends on installation and environmental conditions. For upward facing surfaces of horizontal or sloping reflective insulation in non-vented cavities where no special precautions for prevention of dust ingress have been included, the Total R-Value is calculated based on an emittance for the case of slight dust cover in accordance with AS/NZS4859.1 Paragraph K3.2(a)(ii), unless otherwise stated. For calculation purposes, the air gaps are assumed as still parallel air gaps unless otherwise stated and the membrane continuous.

ELECTRICAL SAFETY WARNING

This product contains aluminium foil which conducts electricity. To avoid electrocution, care should be taken to ensure that this product or conductive fasteners used to secure this product, do not come into contact or close proximity with electrical wiring during installation or use. This product should not be installed in an existing structure in a horizontal orientation such as a ceiling or sub-floor application due to the presence of electrical wiring in the framing.



CSR Bradford
 Locked Bag 1345 North Ryde BC NSW 1670
csrbradford.com.au
 Email: bradfordenquiries@csr.com.au

For further information
 call **1300 850 305** or
 visit bradfordthermoseal.com.au



CSR Bradford is a business division of CSR Building Products Limited ABN 55 008 631 356

The contents of this brochure are copyright protected and may not be reproduced in any form without prior written consent of CSR Bradford. Recommendations and advice regarding the use of the products described in this brochure are to be taken as a guide only, and are given without liability on the part of the company or its employees. We reserve the right to change product specifications without prior notification, please refer to the CSR Bradford website for the latest revision of this document. The purchaser should independently determine the suitability of the product for the intended use and application.