

INSTALLING OPTIMO UNDERFLOOR INSULATION UNDER AN EXISTING FLOOR

TOOLS YOU WILL NEED

- Tape measure
- Hammer and nails or cordless drill and self-tapping screws
- Sharp long bladed knife (in a holster for safety)
- Torch or other lighting

BEFORE YOU START INSTALLING OPTIMO



Switch off power at the fuse box.
Measure your floor joist spaces. Usually 450mm centres or 600mm centres.
For 450mm centres use 415mm wide batts.
For 600mm centres use 565mm wide batts.



STEP 1
Take enough packs into the underfloor area for the whole job where possible. Start fitting insulation from the furthest point from the underfloor access.

Note: As access and workspace can be restricted 2 people may be required for installation.

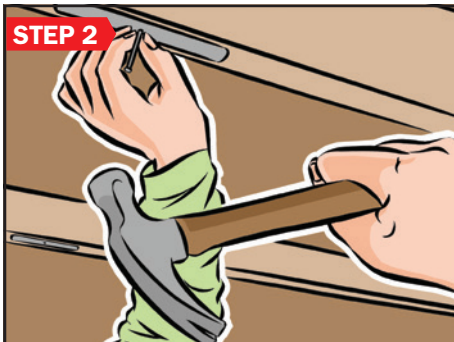

STEP 2
Nail the Optimo aluminium straps to the timber joists every 500mm swivelling them so they run parallel to the joist to leave access to the cavity free to install the insulation. In lieu of hammer & nails you can use drill and self-tapping screws.

Note: For non standard joist spacings additional straps may be required.



STEP 3
Friction fit Optimo batts tightly between the joists and press in place to ensure there are no gaps between the insulation and joists, or abutting edges (ends) of insulation.

Note: If the batt is too tight, trim the edge to 5mm over the width of the space before inserting. If the batt is too loose, slice a piece off the edge of another batt to use as a packer.

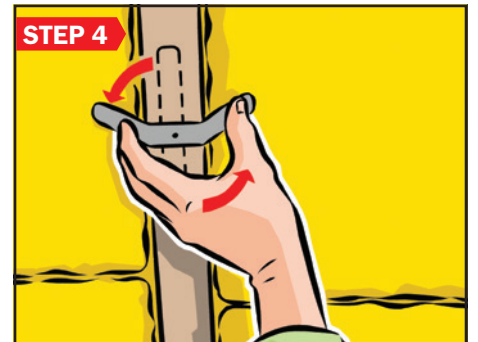

STEP 4
Swivel the Optimo aluminium strap 90° so the strap extends into the floor cavity between the joists and bend the strap upwards to support the insulation.

Note: Take care not to block ventilation openings. Do not leave any gaps between batts.

ELECTRIC CABLES AND SERVICES

- Electric cables and equipment partially or completely surrounded with bulk insulation may overheat and fail.
- If any electrical wiring will be covered by insulation seek advice from an electrician.
- If cables run along the floor joist the strap can be installed on the side of the joist and bent 90° to support Optimo batts.