

# Wall Wrap Installation

## Enviroseal and Thermoseal Wall Wrap

**NOTE:** This Installation Guide is only applicable for use with the products and applications listed below when installed in Australia. Installation details shown in this guide provide general guidance only. For applications and installation details not covered in this guide, please contact your Bradford representative.

## Applicable Products

- Bradford Enviroseal range of wall wrap products
- Bradford Thermoseal range of wall wrap products

For more information on these ranges of products, please refer to applicable Product Technical Statement (PTS) found on the Bradford website.

## Applications

- Applicable for Class 1 residential timber or metal stud frame external walls with brick veneer and lightweight cladding construction.
- The suitability of a wall wrap for the selected application should be assessed in accordance with the Product Technical Statement by an appropriately qualified person prior to purchase or installation.

## Required Installation Items

- Adhesive Tape (Enviroseal Products: Bradford ULTRAtape / Thermoseal Products: 493 aluminium foil tape)
- Double Sided Tape (i.e. Bradford 334 or Enviroseal Double Sided Tape. For fixing to steel flashing and steel frame taping only)
- Tape Applicator
- Staples or Bradford Plasti-Grip Washers or battens
- Staple Gun or Screw/Nail Gun if choosing to use Bradford Plasti-Grip Washers
- Knife (for edge cutting and repairs)
- Ladder
- Appropriate PPE for cutting (e.g. cut resistant gloves) or using a staple gun (e.g. eye protection)

## Storage & Maintenance

- Store the wall wrap in its original packaging in a cool, dry area, away from UV light (direct sunlight).
- These products are not designed to withstand prolonged exposure to the elements - accordingly, the exterior cladding should be installed within 6 weeks. Products exposed during this period should be inspected for damage and repaired or replaced prior to installation of the exterior cladding to

comply with the Product Warranty. Products exposed for longer than the recommended periods will not be covered by the Product Warranty

- The use of additional mechanical fasteners such as Bradford Plasti-Grip Washers should be considered for wall wraps exposed to harsh weather conditions prior to cladding.
- Do not use pressure cleaners, mechanical cleaning devices, chemical agents or mineral-based cleaners on these products.

## General Guidance

- Isolate power before installation.
- **WARNING:** Thermoseal products contain aluminium foil which conducts electricity. To avoid electrocution, care should be taken to ensure that this product or conductive fasteners used to secure this product, do not come into contact or close proximity with electrical wiring during installation or use.
- Where possible, apply tension to remove creases in the wall wrap prior to fixing each layer. Apply the bottom layer of the wall wrap first by affixing the upper edge of each layer before attaching the remainder of the wall wrap.
- Where possible, it is recommended that at least 150mm of material is wrapped around corners when starting or finishing a run of wall wrap.
- When installed for water control, this product must have overlaps of minimum 150mm, or 50mm and be taped on the exterior face. It is recommended that an appropriate Adhesive Tape (i.e. Bradford ULTRAtape for Enviroseal products or 493 aluminium foil tape for Thermoseal products) is used to seal all vertical joints against water ingress. Where possible, vertical joints should be positioned over and fixed to a stud. All horizontal joints should have the upper wall wrap applied on top of the lower wall wrap to shed water away from the frame.
- When installed as an air barrier, the product should be sealed at overlaps, end laps, discontinuities and penetrations by suitable means such as an Adhesive Tape.
- The printed side of the wall wrap must be facing outward.
- Cuts and tears are recommended to be sealed using an appropriate Adhesive Tape, covering the damaged area with an additional 20mm at each end. For larger tears or damage, patch over with a new wall wrap piece and tape to seal edges.
- Double sided tape such as Bradford 334 or Enviroseal Double Sided Tape can be used to temporarily retain the wall wrap on steel frame construction prior to the application of mechanical fixings or battens.
- Adhesive tape is not a substitute for mechanical fixings and is only suitable for sealing joints, overlaps, and to adjacent construction elements. Tape should not be applied under mechanical load and is only suitable for sealing joints which are supported by mechanical fixings to prevent loads stressing the tape bond.
- Adhesive tape must be applied to a clean & dry surface – firm application pressure must be applied over the tape surfaces, ideally using a suitable tape applicator such as a squeegee – where possible, position joints over framing to provide support.

## Installation Instructions

### Step 1 - Lower layer

- Start a minimum of 150mm around the corner of the frame and fix the edge of the wall wrap to the stud and bottom plate with staples or galvanised screws/nails with Bradford Plasti-Grip Washers.
- Roll out the wall wrap horizontally along the frame, keeping enough pressure to ensure there is no sagging, fixing it to the studs and bottom plate with staples every 150mm or with galvanised screws/nails and Bradford Plasti-Grip Washers every 300mm. If fixing to a frame using Bradford Plasti-Grip Washers, it is recommended to leave at least 180mm from the top of the wall wrap unfixated to allow both the upper and lower layers of wall wrap to be fixed to the frame together with one fastener when the upper layer is installed.
- When approaching an inward corner, fully expand a length of wall wrap and use a timber block to apply pressure into the corner. Press the wall wrap evenly and fix it to both corner studs.

#### Note:

- Applying the roll tightly across the studs allows for easier taping. It may also reduce sag in the wall wrap, making the installation more effective and reducing draughts and moisture entry.
- Fixing the wall wrap with Bradford Plasti-Grip Washers increases wind burst resistance, making it harder to blow off during heavy winds. When using battens, position the washers between battens at each frame.

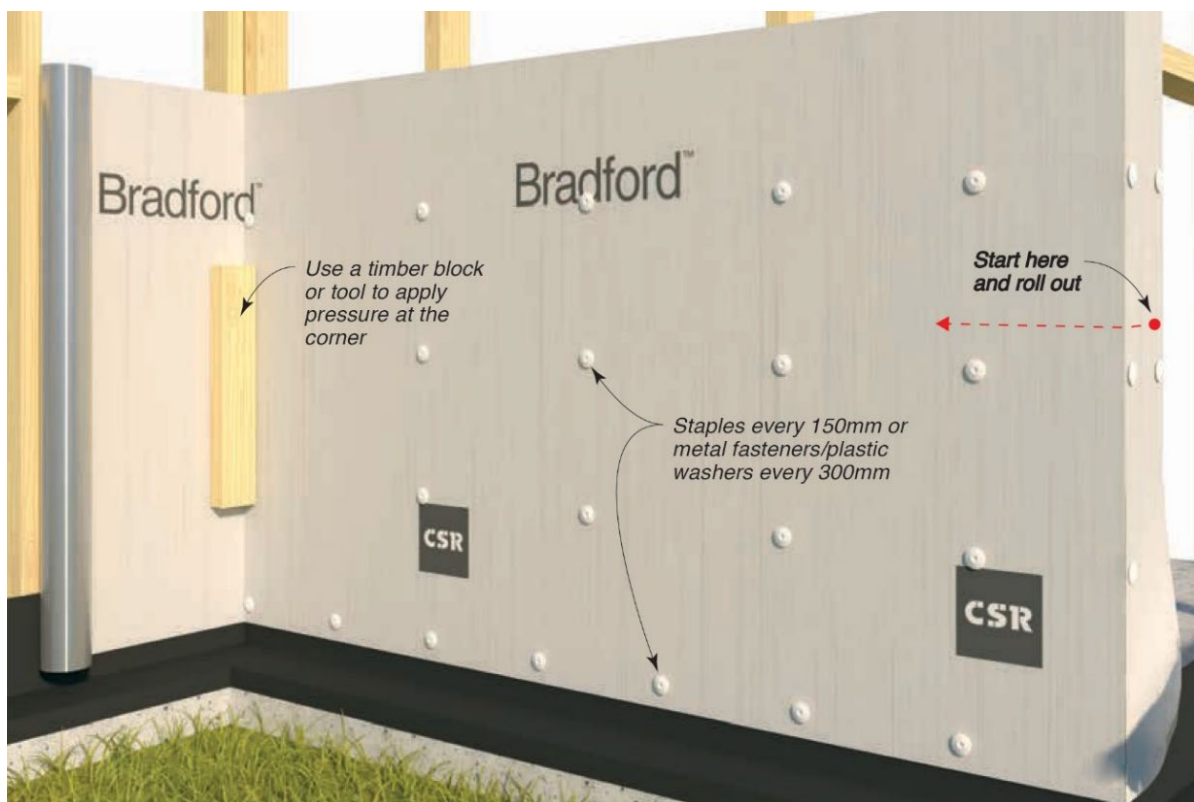

## Step 2 – Overlapping Two Rolls Ends

- Apply additional rolls to the wall frame horizontally. The additional roll of wall wrap should overlap the end of the existing roll by at least 50mm and both layers should be fixed to a stud using staples or galvanised screws/nails with Bradford Plasti-Grip Washers.
- Once the overlapped layer is fixed to the stud, continue to roll horizontally, keeping a tight pressure on the wall wrap as it is applied.
- Fix the wall wrap to the stud and bottom plate with staples every 150mm or with galvanised screws/nails and Bradford Plasti-Grip Washers every 300mm.

### Note:

- *Overlaps should always be horizontal or vertical, not diagonal or any other angle. It's recommended that an appropriate Adhesive Tape is used to seal the joint to prevent draughts and water ingress.*
- *When applying tape to overlaps, it is important to consider an even spread of tape surface over both laps. If the tape is 60mm wide, the top and bottom layers of wall wrap should each receive 30mm of tape when being applied.*

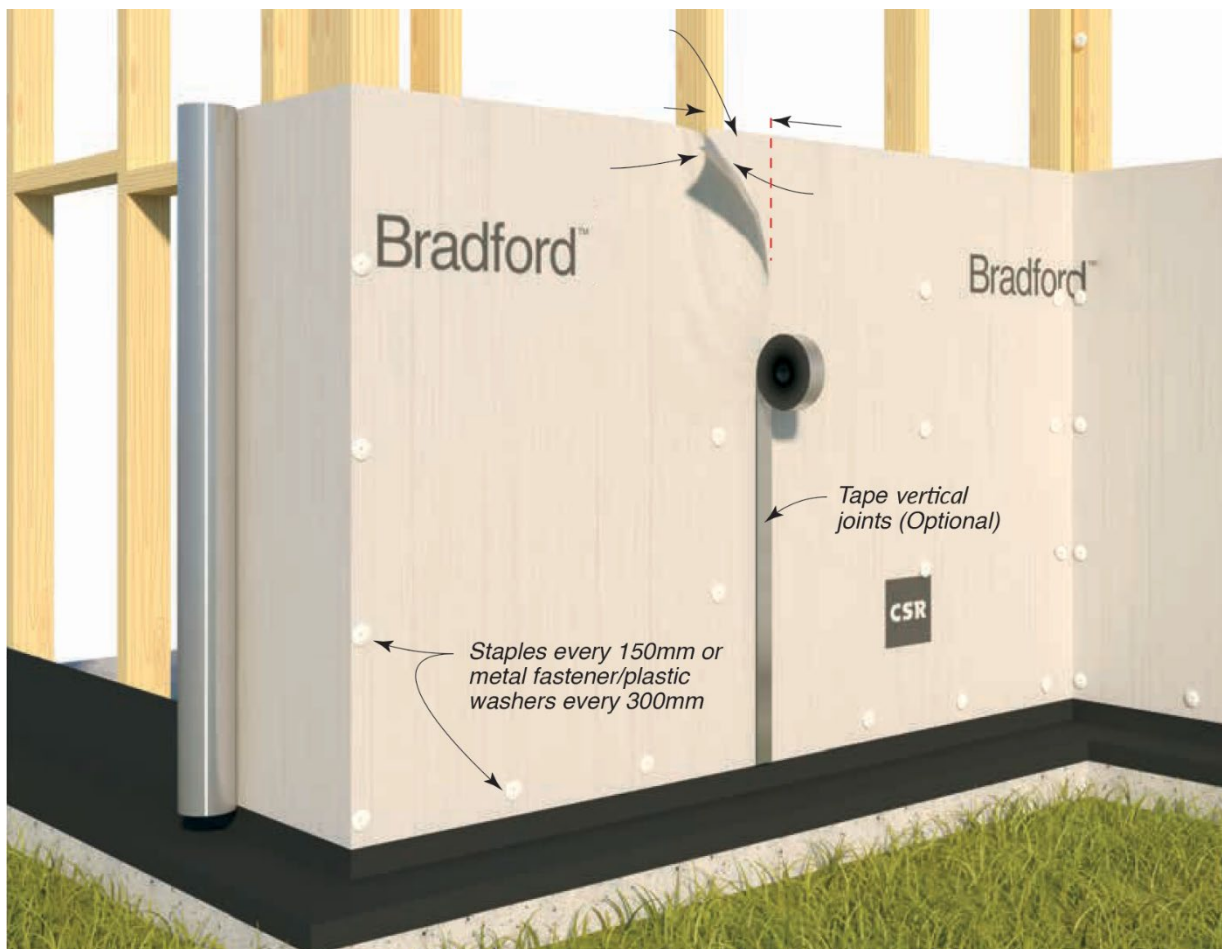

## Step 3 – Upper Layer

**Safety warning:** This section requires the use of a ladder to reach and install the wall wrap along the top portion of the frame. It is critical that all obstacles must be removed from around the slab that could increase the risk of injury.

- Commence installing the upper roll in a staggered starting position from where the lower layer was started.
- The upper layer of wall wrap should overlap (on the outside) the bottom layer of wall wrap by at least 150mm or 50mm and be taped on the exterior face.
- Fix the upper layer to the stud and align to the top edge of the top plate (if possible whilst maintaining a 150mm overlap), then begin rolling the wall wrap out horizontally in the same direction as the original layer.
- Continue to roll out the wall wrap fixing it with staples every 150mm or with galvanised screws/nails and Bradford Plasti-Grip Washers every 300mm.
- When approaching an inward corner, fully expand a length of wall wrap and use a timber block to apply pressure into the corner. Press the wall wrap evenly and fix it to both studs.

**Note:**

- *Overlapping a minimum 150mm and sealing with tape minimises external moisture or draughts from entering the wall cavity.*
- *Always maintain tension when installing wall wrap, to ensure consistent sealing of overlaps.*



## Detail Appendix

### Doorways

When installing a wall wrap around a door frame it is important that no gaps are present in the corners and along the timber stud frame. To achieve this, appropriate cutting and folding of the wall wrap is recommended.

#### Step 1 – Doorway Bottom Layer

- Completely cover the bottom of the door frame cavity by extending the wall wrap across the entire wall. Be sure to keep tension on the wall wrap do not allow any sagging.
- Fix the wall wrap to both sides of the door frame with staples every 150mm or with galvanised screws/nails and Bradford Plasti-Grip Washers every 300mm. If fixing to a frame using Bradford Plasti-Grip Washers, it is recommended to leave at least 180mm from the top of the wall wrap unfixed to allow both the upper and lower layers of wall wrap to be fixed to the frame together with one fastener when the upper layer is installed.
- Cut directly down the middle of the wall wrap so each side can be folded around the door frame. Keep tension on the wall wrap and fix it again on the inside edge of the doorway.
- Cut off any excess wall wrap so it is flush with the stud's inner edge.

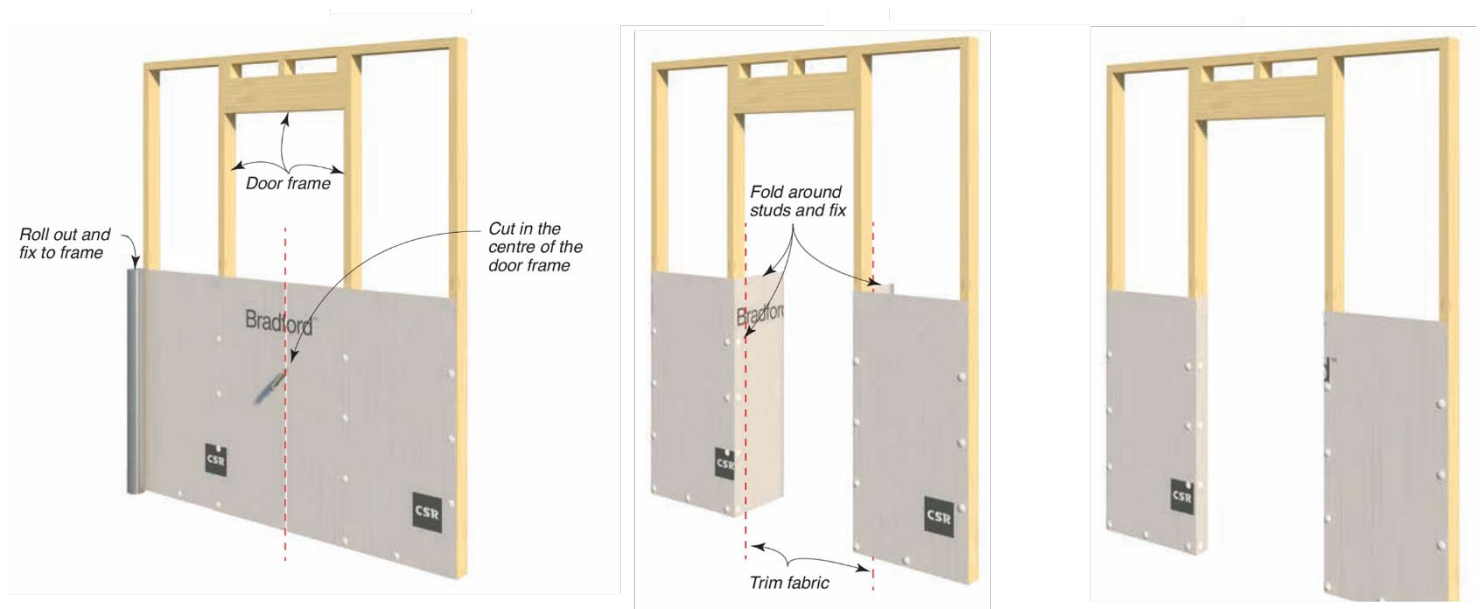

## Step 2 – Doorway Upper Layer

- Completely cover the top part of the door frame cavity by extending the wall wrap across the entire wall. Be sure to keep tension on the wall wrap to not allow any sagging.
- Fix the wall wrap along the head of the doorway and on both sides of the door frame with staples every 150mm or with galvanised screws/nails and Bradford Plasti-Grip Washers every 300mm.
- Cut a Y shape into the wall wrap so it can be folded upwards around the header and around both sides of the frame.
- Fold each flap around the frame and fix.
- Cut off any excess wall wrap so it is flush with the edge of each stud.
- Optionally apply tape to all joints.

### Note:

- Alternatively, the Y cut can be extended further to accommodate head flashing over doorway. Lift upper flap, install flashing and tape membrane to flashing. Use tape to seal Y cut openings to flashing and adjoining material.

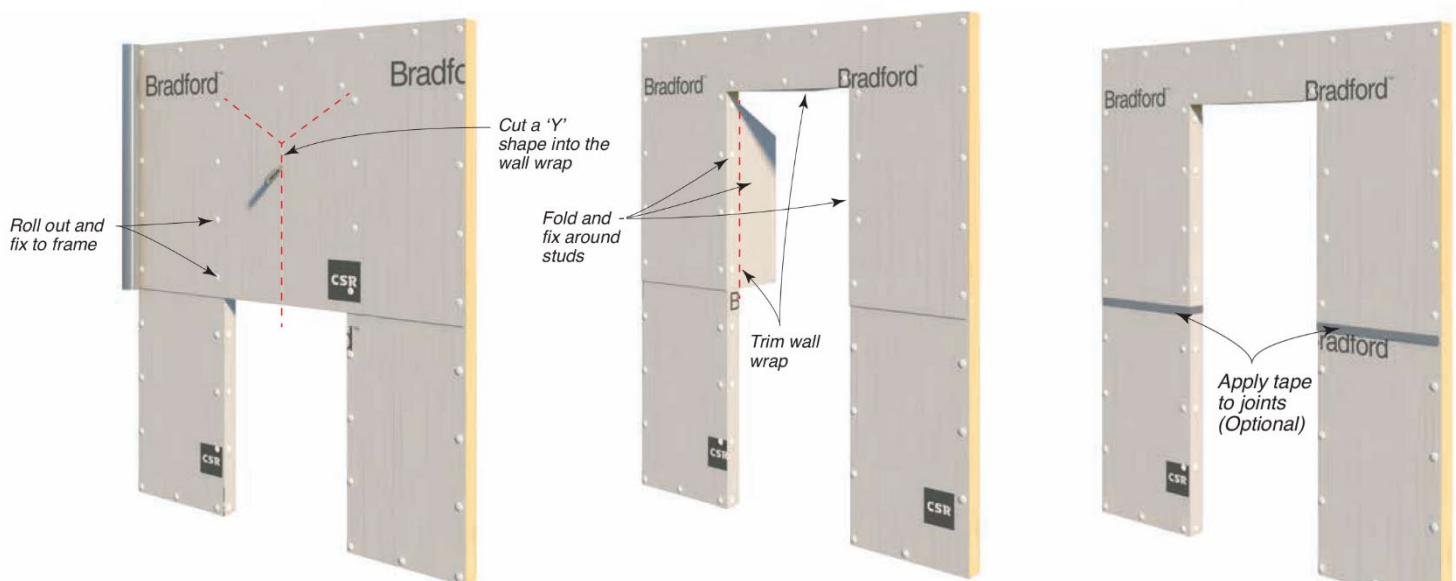

## Windows

Installation of wall wraps at window openings should be in accordance with AS4200.2. For a range of installation options on the preparation and taping of window openings, refer to the following document on the [www.bradfordinsulation.com.au](http://www.bradfordinsulation.com.au) website

- Bradford Wall Wrap Window Penetrations Install Guide

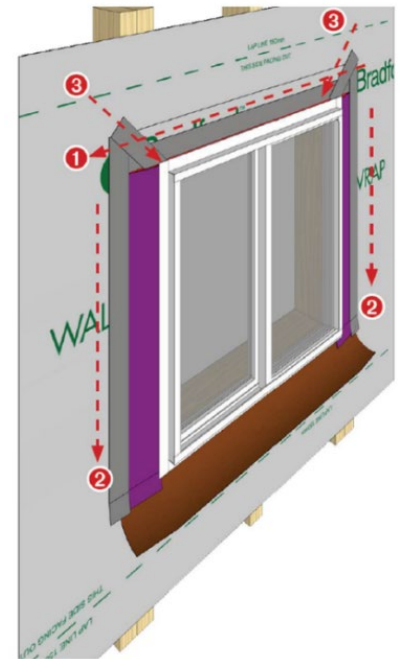

## Sealing Overlaps, Penetrations, Cuts, Tears and Repairs

For full details on tape usage with wall wraps including sealing overlaps, penetrations, cuts, tears and repairs, refer to the following document on the [www.bradfordinsulation.com.au](http://www.bradfordinsulation.com.au) website

- Bradford ULTRAtape Installation guide

