

RECAP

This week, Harry and Tash created a grand, luxurious bedroom with all the right hints of 1920's. Using a muted colour palette, they used the large space to their advantage with skylights and feature wallpaper to make a statement.

JUDGES' HIGHLIGHTS

"The vaulted ceilings, that pitched roof, gives you this opportunity for this grandeur and this grace." - Darren

"They've got that nod to the period right in this room and I feel that the modern elements are not clashing." - Shaynna

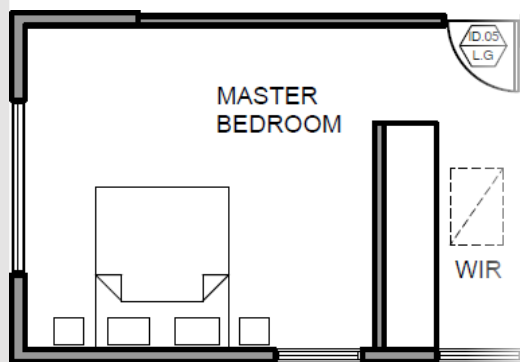

Master Bedroom Renovation Checklist

WALLS

- External Walls
- Bradford Gold Hi-Performance Insulation ☐
- Internal Walls
- Bradford SoundScreen Acoustic Insulation ☐
- Gyprock Superchek Plasterboard ☐
- Emerald Crane Wallpaper ☐

CEILING

- Bradford Gold Hi-Performance Insulation ☐
- Gyprock Supaceil Plasterboard ☐
- Velux Solar Powered Skylights ☐

FLOORS

- Bradford Optimo Underfloor Insulation ☐

FITTINGS & FURNISHINGS

- Freedom Furniture accent chairs ☐
- Empire 10 Light Chandelier in Black by Beacon ☐
- Haiku by Big Ass Fans in Black ☐

PRODUCT IN FOCUS

Harry and Tash used Bradford Gold Hi-Performance in the external walls of the home, keeping bedrooms warmer in winter and cooler in summer. For more info, visit TotalHomeComfort.com.au



AVAILABLE
AT MITRE 10

CSR