



Martini Easy Baffle

- Easy Baffle is thermally bonded polyester fibre insulation specifically designed to reduce flanking sound transmission through suspended ceiling voids in offices and institutions such as education, healthcare and civic buildings.
- Non-irritant and does not require any protective clothing or masks during installation.
- Available in standard white colour. Black or grey available upon request.

Applications

Easy baffle is designed to fill the void above partition walls to control flanking noise between adjoining spaces in commercial and multi-residential buildings.

Acoustic performance

When placed between a concrete slab soffit and the top junction of a plasterboard partition wall, Easy Baffle can achieve a sound transmission reduction of up to 9–16 decibels across a range of frequencies including general speech range frequencies – the most common nuisance noise in commercial buildings.

Easy Baffle has a Noise Reduction Coefficient (NRC) of 0.9 as tested in accordance with AS/ISO 354-2006.

Environmental benefits

Easy Baffle is manufactured from thermally bonded polyester fibre with up to 80% recycled fibre content from post-consumer PET packaging such as empty drink bottles. The product is 100% recyclable and has very high reuse potential as insulation. CSR Martini’s Product Stewardship Program can be viewed at www.csrmartini.com.au.

- No chemicals or resin binders are used in manufacture.
- Odourless and contains no harmful volatile organic compounds (VOC).
- No waste is generated in manufacture.
- No water or ozone-depleting gases are used in manufacture.
- No chlorides are present in the product.
- Suitable for use in Green Star™ projects.

Pack specifications

Length (mm)	Pack width (mm)	Pack depth (mm)	Batts per pack	NRC	Product Code
1200	600	450	8	0.9	129188

www.csrmartini.com.au



green building council australia
MEMBER





Installation

Martini Easy Baffle is easy to install in ceiling voids. The product is packaged in a compressed form to a thickness of 450mm. One pack of Martini Easy Baffle is designed to fit in a ceiling to soffit height of 600mm. To work effectively, Martini Easy Baffle must be compressed by 30%.

If the void is greater than 600mm in height, add one extra batt for every 65mm over 600mm. The product can be made to order to suit other void heights subject to minimum quantities.

Installed in five easy steps:

1. Cut off both ends off the pack leaving the batts in the remaining sleeve.
2. Insert the batts in their sleeve into the void.
3. Centre the pack length-ways to follow the partition centre line.
4. Slit the remaining plastic sleeve and remove; the batts will then expand to fill the void. At 600mm void height, 30% compression is achieved.
5. Adjust batts to form an even stack for the next pack to adjoin to.

Where services such as HVAC ducts, pipes and cable trays run through the void then batts should be installed individually under, over and around the obstruction to a suitable compression.

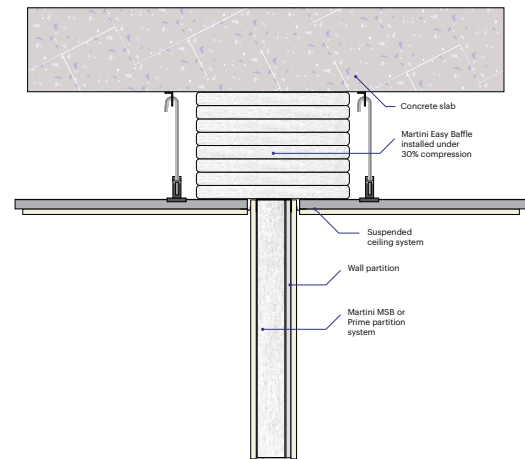

Physical description and properties

Volatiles:	Nil												
Specific Gravity:	1.38												
Flash Point:	None allocated												
Other Properties:	Non-allergenic, low irritant, low flame response, resilient												
Ingredients:	Organic, long chain synthetic polymer												
Max Service Temp:	150°C												
Alkalinity:	pH 7.8 (pH 7 is neutral)												
Moisture Absorption:	Exposure to an atmosphere of 50°C & 95% RH for four days gives moisture absorption of less than 0.2% by volume												
Fire Resistance:	<table border="1"> <tr> <td>The following results were obtained when CSR Martini product was subjected to early fire hazard testing in accordance with Australian Standards AS 1530.3.</td> <td>Ignitability</td> <td>0</td> </tr> <tr> <td></td> <td>Spread of Flame</td> <td>0</td> </tr> <tr> <td></td> <td>Heat Evolved</td> <td>0</td> </tr> <tr> <td></td> <td>Smoke Developed</td> <td>0-1</td> </tr> </table>	The following results were obtained when CSR Martini product was subjected to early fire hazard testing in accordance with Australian Standards AS 1530.3.	Ignitability	0		Spread of Flame	0		Heat Evolved	0		Smoke Developed	0-1
The following results were obtained when CSR Martini product was subjected to early fire hazard testing in accordance with Australian Standards AS 1530.3.	Ignitability	0											
	Spread of Flame	0											
	Heat Evolved	0											
	Smoke Developed	0-1											

Disclaimer: The contents of this brochure are copyright protected and may not be reproduced in any form without prior written consent of CSR Martini. Recommendations and advice regarding the use of the products described in this brochure are to be taken as a guide only, and are given without liability on the part of the company or its employees. We reserve the right to change product specifications without prior notification, please refer to the CSR Martini website for the latest version of this document. The purchaser should independently determine the suitability of the product for the intended use and application.

www.csrmartini.com.au

Distributed by:



CSR Bradford
Locked Bag 1345 North Ryde BC NSW 1670
csrbradford.com.au
Email: bradfordenquiries@csr.com.au

For further information
call **1300 850 305** or
visit bradfordinsulation.com.au

